

Deep Cycle SLA Battery

DC SERIES

DC (Deep cycle) Series batteries are designed for deep discharge application, with special chemical formula for plates active paste material, slightly stronger electrolyte and low temperature design, which can withstand repeated deep cyclic application, such as Solar Energy System, Golf Trolley, Electric

Application

- Solar Energy System
- Golf Cars and Buggies
- Electric Powered Vehicles
- Wheel Chairs
- Power Tools
- Electric Powered Toys
- Control System
- Vacuum Cleaners
- Medical Equipments
- UPS

General Features

- Sealed and maintenance free operation.
- Non-Spillable construction design.
- ABS containers and covers(UL94HB, UL94V-0) optional.
- Safety valve installation for explosion proof.
- High quality and high reliability.
- Exceptional deep discharge recovery performance.
- Low self discharge characteristic.
- Flexibility design for multiple install positions.

Construction

- ComponentRaw material
- PositiveLead dioxide
- NegativeLead
- ContainerABS
- CoverABS
- SealantEpoxy Resin
- Safety valveEPDR
- TerminalCopper
- SeparatorFibre glass
- ElectrolyteSulfuric acid

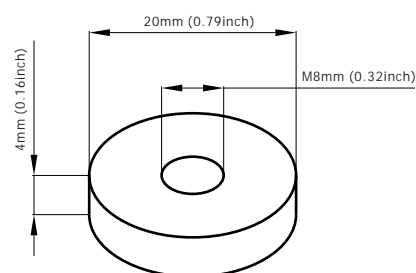

Terminal Dimensions

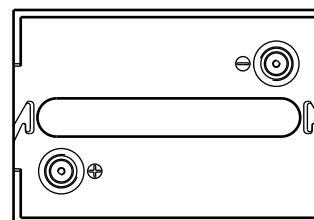
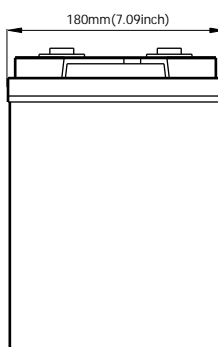
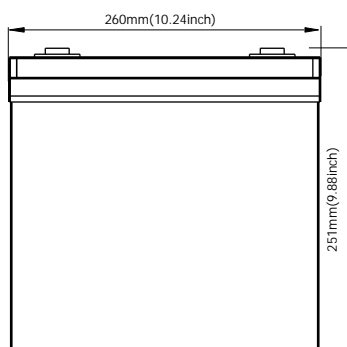

Battery Model	DC 6-150			
Designed Cycle Life	> 350 cycles @ -0.5CA to 4.8V			
Capacity(25°C)	20HR(7.7A,1.75V)	10HR(15A,1.75V)	5HR(25.5A,1.75V)	1HR(96A,1.75V)
	154AH	150AH	127.5AH	96AH
Dimensions	Length	Width	Height	Total Height
	260mm(10.2inch)	180mm(7.09inch)	247mm(9.72inch)	251mm(9.88inch)
Approx. Weight	27Kg (59.54lbs)			
Internal Resistance	Full charged at 25°C: 0.004 Ohm			
Self Discharge	3% of capacity declined per month at (25°C)			
Capacity Affected by Temp.(20HR)	40°C	25°C	0°C	-15°C
	102%	100%	85%	65%
Charge Voltage(25°C)	Cycle use		Float use	
	7.2-7.5V(-15mV/ °C), max. Current: 45A		6.8-6.9V(-10mV/ °C)	

Deep Cycle SLA Battery

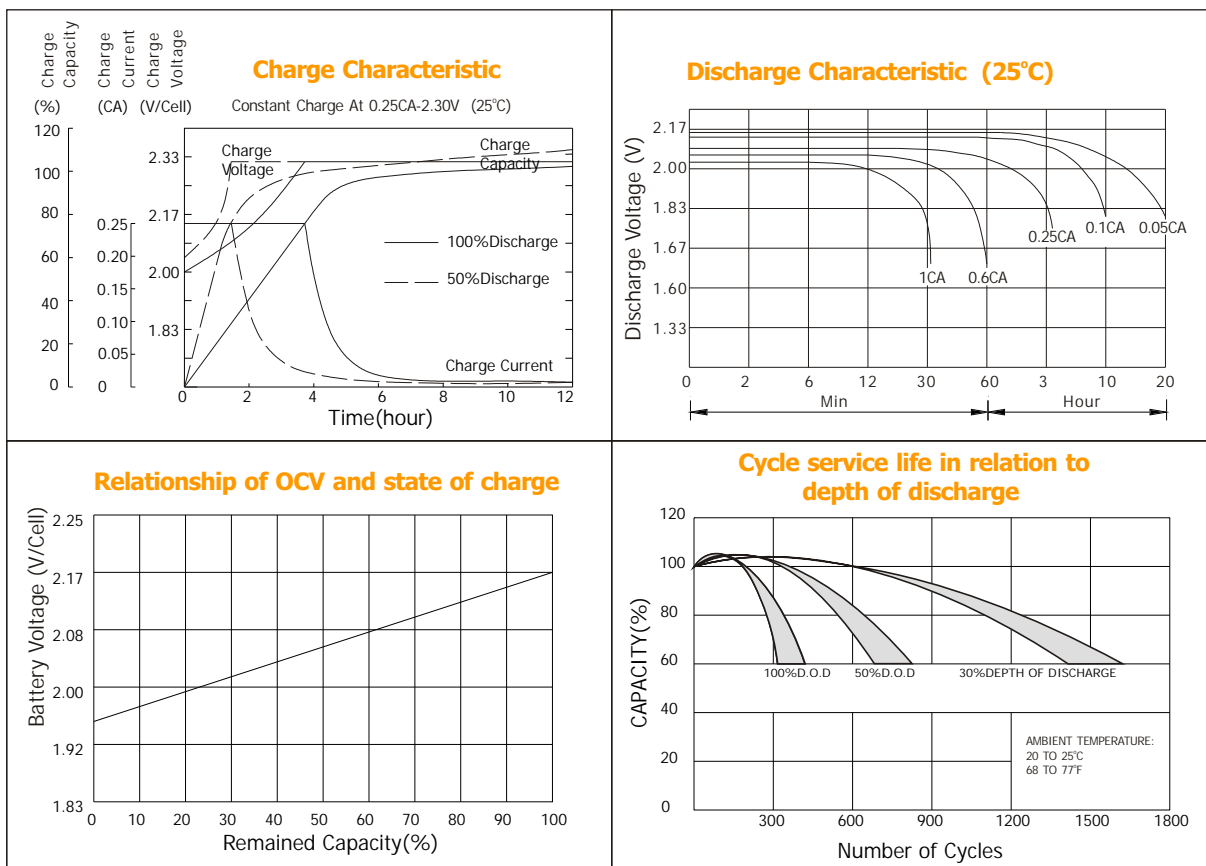

Constant current discharge ratings-amperes at 25°C

F.V/Time	5MIN	10MIN	15MIN	30MIN	1HR	3HR	5HR	10HR	20HR
1.60V	656	408	308	188	109	48.0	29.4	16.0	8.64
1.67V	616	387	296	180	108	46.2	28.7	15.8	8.34
1.70V	564	373	289	163	105	43.1	28.1	15.8	8.21
1.75V	553	361	280	155	99.8	41.7	27.5	15.7	7.99
1.80V	495	345	254	144	93.4	40.0	25.9	15.4	7.78
1.85V	437	329	229	132	87.1	38.6	24.2	15.2	7.56

Constant power discharge ratings-watts at 25°C

F.V/Time	5MIN	10MIN	15MIN	30MIN	1HR	3HR	5HR	10HR	20HR
1.60V	1151	737	562	338	198	85.2	49.6	32.9	17.2
1.67V	1110	718	555	331	196	82.5	49.4	32.6	16.6
1.70V	1045	711	550	310	193	78.8	48.8	31.6	16.4
1.75V	1052	709	546	301	189	77.0	48.3	31.4	16.0
1.80V	963	698	506	287	178	74.7	46.8	30.8	15.6
1.85V	873	663	459	269	168	72.5	45.3	30.4	15.3

